

vtech[®]

Instruction Manual

SWITCH&GO[®] **DiNOS**

Tremor the T-Rex

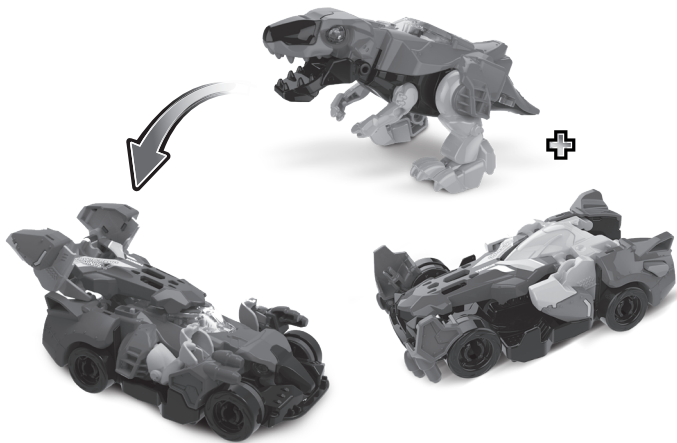

VTech understands that a child's needs and abilities change as they grow and with that in mind we develop our toys to teach and entertain at just the right level...

vtech Baby

Toys that will stimulate their interest in different textures, sounds and colours

I am...

...responding to colours, sounds and textures

...understanding cause and effect

...learning to touch, reach, grasp, sit-up, crawl and toddle

Birth-36 months



Pre-School

Interactive toys to develop their imagination and encourage language development

I want...

...to get ready for school by starting to learn the alphabet and counting

...my learning to be as fun, easy and exciting as can be

...to show my creativity with drawing and music so my whole brain develops

3-6 years



Electronic Learning Computers

Cool, aspirational and inspiring computers for curriculum related learning

I need...

...challenging activities that can keep pace with my growing mind

...intelligent technology that adapts to my level of learning

...National Curriculum based content to support what I'm learning at school

4-10 years



To learn more about this and other VTech® products, visit www.vtech.co.uk

INTRODUCTION

Time to roar with **Switch & Go Dinos® Tremor the T-Rex**. This 2-in-1 toy combines a fierce T-Rex with a cool super car, which combine to make a Mega Power Car!

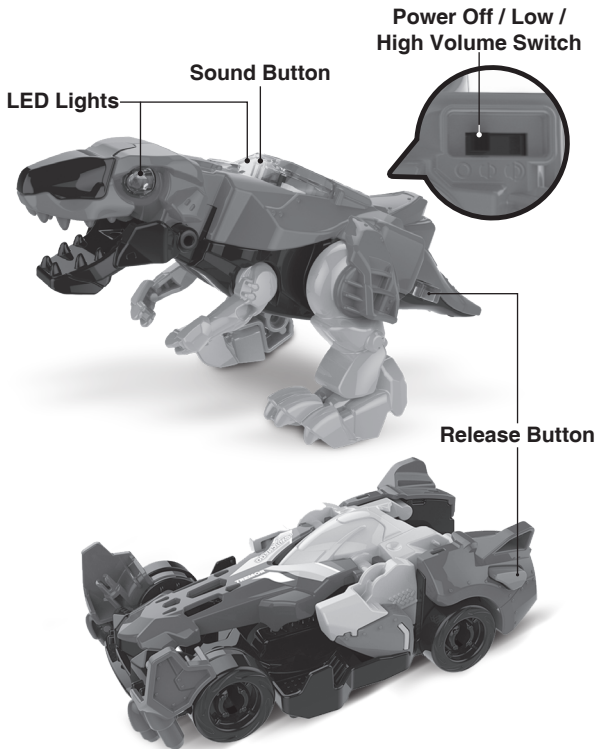

INCLUDED IN THE PACKAGE

- One T-Rex
- One Super Car
- One Quick Start Guide

WARNING:

All packing materials such as tape, plastic sheets, packaging locks, removable tags, cable ties, cords and packaging screws are not part of this toy, and should be discarded for your child's safety.

NOTE:

Please save this Instruction Manual as it contains important information.

WARNING:

Do not aim at eyes or face.

WARNING:

Do not discharge any object other than the projectile provided with this toy.

GETTING STARTED

Exit Try-Me Mode:

Switch & Go Dinos® Tremor the T-Rex is in try-me mode in the packaging. To exit try-me mode, combine the T-Rex with the super car to form the Mega Power Car, or replace the battery. Normal play mode will then be activated.

WARNING:

Adult assembly required for battery installation.
Keep batteries out of reach of children.

Battery Removal and Installation

1. Make sure the unit is turned OFF.
2. Locate the battery cover on the bottom of the unit. Use a screwdriver to loosen the screw and then open the battery cover.
3. If a used battery is present, remove this battery from the unit by pulling up on one end of the battery.
4. Install 1 new AAA (AM-4/LR03) battery following the diagram inside the battery box. (For best performance, alkaline batteries or fully charged Ni-MH rechargeable batteries are recommended).
5. Replace the battery cover and tighten the screw to secure.

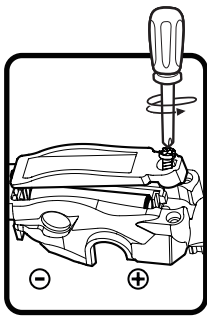

IMPORTANT: BATTERY INFORMATION

- Insert batteries with the correct polarity (+ and -).
- Do not mix old and new batteries.
- Do not mix alkaline, standard (carbon-zinc) or rechargeable batteries.
- Only batteries of the same or equivalent type as recommended are to be used.
- Do not short-circuit the supply terminals.
- Remove batteries during long periods of non-use.
- Remove exhausted batteries from the toy.
- Dispose of batteries safely. Do not dispose of batteries in fire.

RECHARGEABLE BATTERIES:

- Remove rechargeable batteries (if removable) from toy before charging.
- Rechargeable batteries are only to be charged under adult supervision.
- Do not charge non-rechargeable batteries.

Disposal of batteries and product



The crossed-out wheellie bin symbols on products and batteries, or on their respective packaging, indicates they must not be disposed of in domestic waste as they contain substances that can be damaging to the environment and human health.

The chemical symbols Hg, Cd or Pb, where marked, indicate that the battery contains more than the specified value of mercury (Hg), cadmium (Cd) or lead (Pb) set out in the Batteries and Accumulators Regulation.



The solid bar indicates that the product was placed on the market after 13th August, 2005.

 Please dispose of your product and batteries responsibly.

In the UK, give this toy a second life by disposing of it at a small electricals collection point* so all of its materials can be recycled.

Learn more at:



www.vtech.co.uk/recycle

www.vtech.com.au/sustainability

* Visit www.recyclenow.com to see a list of collection points near you.

PRODUCT FEATURES

1. Power Off / Low / High Volume Switch

To turn the unit **On** or to adjust the volume, slide the **Power Off / Low / High Volume Switch** to the Low  or High  Volume position. To turn the unit Off, slide the switch to the **Off**  position.

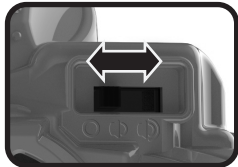

2. Sound Button

Press the **Sound Button** to learn fun Dino facts and hear cool dinosaur sounds in T-Rex mode or hear fun phrases and vehicle sounds in Mega Power Car mode.

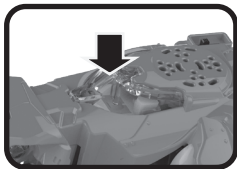

3. Release Button

In T-Rex mode, if the T-Rex's legs have been flipped up, press the **Release Button**, T-Rex's legs will pop out.

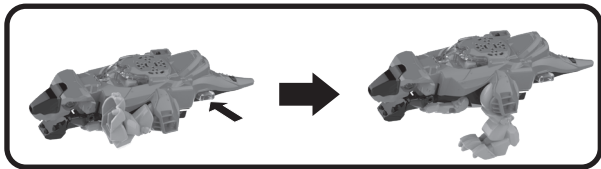

In Mega Power Car mode, pressing the **Release Button** will launch the T-Rex and make it jump forward. Do not aim towards children's faces or eyes before pressing the button.

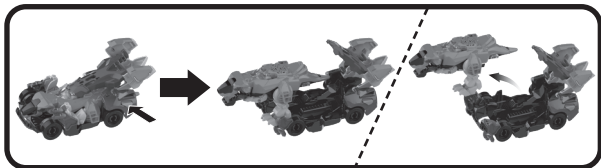

Note: The T-Rex's legs can be flipped up by hand and can pop out with the **Release Button**.

4. LED Lights

The eyes and body **LED Lights** flash along with the sounds in T-Rex mode and Mega Power Car mode.

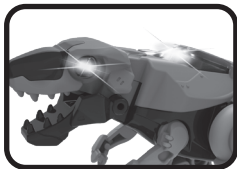

5. Automatic Shut-Off

To preserve battery life, **Switch & Go Dinos® Tremor the T-Rex** will automatically power down after several seconds without input. The unit can be turned on again by pressing the Game Button. The unit will also automatically turn off when battery power is very low.

Note: If the unit repeatedly powers down or has abnormal responses when the unit is switched on, please install a brand new battery and try switching it on again.

Combination

Combine to form a Mega Power Car

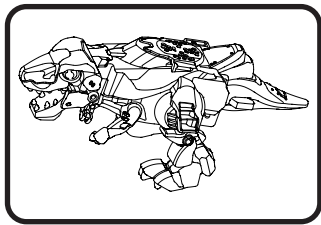

1. Begin in T-Rex mode.

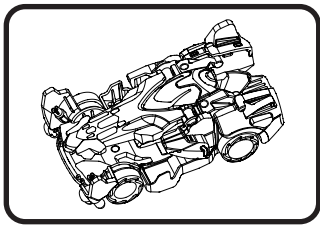

2. Begin as super car.

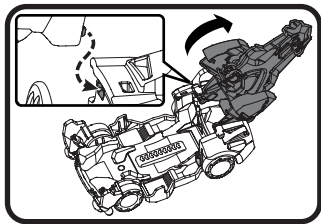

3. Flip up the entire super car's roof.

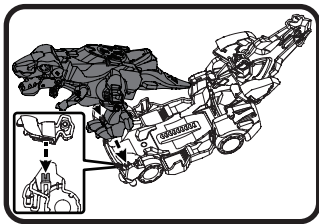

4. Insert the stubs into the round holes at the bottom of the T-Rex's feet.

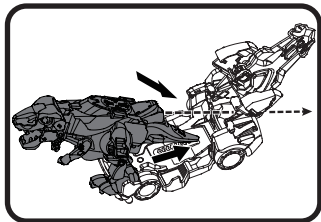

5. Push the T-Rex down into the car.

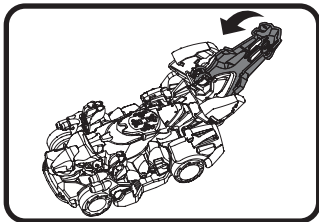

6. Flip back the super car's roof.

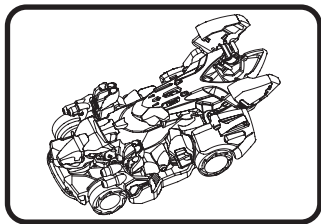

7. Mega Power Car mode.

Auto-switch into a T-Rex

1. If the T-Rex is not attached to the super car tightly.

Press the release button, the T-Rex will pop out from the super car.

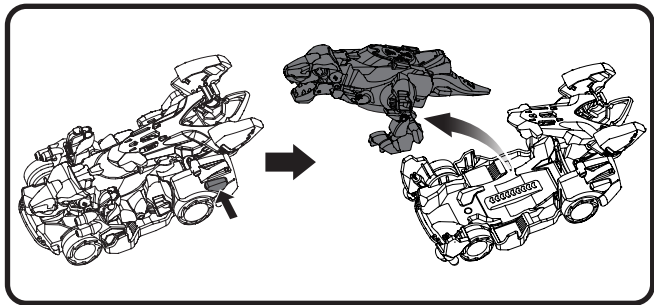

2. If the T-Rex is attached to the super car tightly.

Press the release button, the T-Rex launches and stands on the super car.

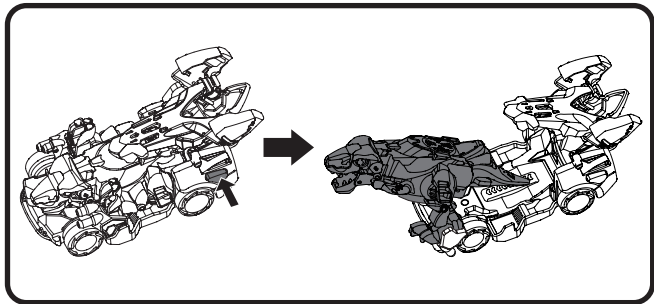

CARE & MAINTENANCE

1. Keep the unit clean by wiping it with a slightly damp cloth.
2. Keep the unit out of direct sunlight and away from any direct heat source.
3. Remove the battery when the unit is not in use for an extended period of time.
4. Do not drop the unit on hard surfaces and do not expose the unit to moisture or water.

TROUBLESHOOTING

If for some reason the program/activity stops working or malfunctions, please follow these steps:

1. Please turn the unit **OFF**.
2. Interrupt the power supply by removing the battery.
3. Let the unit stand for a few minutes, then replace the battery.
4. Turn the unit **ON**. The unit should now be ready to play with again.
5. If the product still does not work, install a brand new battery.

If the problem persists, please contact our Consumer Services Department and a service representative will be happy to help you.

CONSUMER SERVICES

Creating and developing **VTech®** products is accompanied by a responsibility that we at **VTech®** take very seriously. We make every effort to ensure the accuracy of the information, which forms the value of our products. However, errors sometimes can occur. It is important for you to know that we stand behind our products and encourage you to call our Consumer Services Department with any problems and/or suggestions that you might have. A service representative will be happy to help you.

UK Customers:

Phone: 0330 678 0149 (from UK) or +44 330 678 0149 (outside UK)

Website: www.vtech.co.uk/support

Australian Customers:

Phone: 1800 862 155

Website: support.vtech.com.au

NZ Customers:

Phone: 0800 400 785

Website: support.vtech.com.au

PRODUCT WARRANTY/ CONSUMER GUARANTEES

UK Customers:

Read our complete warranty policy online at vtech.co.uk/warranty.

Australian Customers:

VTECH ELECTRONICS (AUSTRALIA) PTY LIMITED –
CONSUMER GUARANTEES

Under the Australian Consumer Law, a number of consumer guarantees apply to goods and services supplied by VTech Electronics (Australia) Pty Limited. Please refer to vtech.com.au/consumerguarantees for further information.

**Visit our website for more
information about our products,
downloads, resources and more.**

www.vtech.co.uk
www.vtech.com.au

